

ON-PREMISES PREMIUM SINGLE TUMBLE DRYER

NT120

120lb



FEATURES

- Easy-to-use digital control
- Electric, gas and steam heating
- Large door opening for easy loading and unloading
- Galvanized cylinder
- Radial airflow
- Standard reversing cylinder to avoid tangling of large items
- Large self-cleaning lint screen
- Preheating of intake air

OPTIONS

- Stainless steel cylinder
- Stainless steel front panel
- Sensodry+[®] over-dry prevention technology lowers energy, utility and linen replacement costs
- SafeTech[™] Fire Suppression System, a multi-port water manifold system, will saturate linens in an unlikely event of fire within the cylinder



FAST DRYING



EASY
OPERATION



SERVICE
FRIENDLY

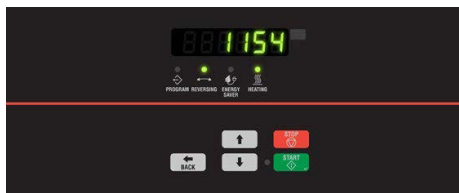

XQ Control

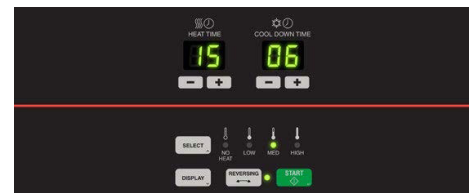

Dual Digital Control



You have plans. We have solutions.

1.844.275.2828 | www.lavxel.com

MODEL			NT120
CONTROL OPTION			XQ, DDC
CAPACITY - lb (kg)			120 (54)
OVERALL WIDTH - in (mm)			46.38 (1178)
OVERALL DEPTH - in (mm)			67.92 (1725)
OVERALL HEIGHT - in (mm)		Gas/Electric	85.7 (2177)
		Steam	83.5 (2121)
CYLINDER DIAMETER - in (mm)			44 (1118)
CYLINDER VOLUME - cu. ft (liters)			36.1 (1022)
DOOR OPENING SIZE - in (mm)			26.88 (683)
ENERGY DATA		Steam Models - 100 psi	405,000 Btu/h
		Electric Models	60 kW
		Gas Models	270,000 Btu/h
EXHAUST - in (mm)			10 (254)
GAS CONNECTIONS - one manifold - in (npt)			1
STEAM CONNECTIONS - in (npt)			0.75
MOTOR - hp		Fan	1
		Drive	0.75
DRYING AVERAGE - lbs/min		Gas Heating	1.94
		Electric Heating	1.77
AIRFLOW - cfm			1600
ELECTRIC SPECS - amps			Rev
GAS & STEAM		200-208/240/60/3 3W+G	7.7
		380/60/3 3W+G	4.1
		*Steam Only - 440/60/3 3W+G	3.8
		460-480/60/3 3W+G	3.9
ELECTRIC		240/60/3 3W+G	152
		380/60/3 3W+G	94.5
		480/60/3 3W+G	76.1
SHIPPING DIMENSIONS - in (mm)		Width	48.5 (1232)
		Depth	71.5 (1816)
		Height	90 (2286)
NET WEIGHT - lb (kg)		Gas/Electric	1275 (578)
		Steam	1375 (624)
SHIPPING WEIGHT - lb (kg)		Gas/Electric	1338 (607)
		Steam	1446 (656)
AGENCY APPROVALS			cCSAus

*The data concerning dimensions of machines includes all extended parts.

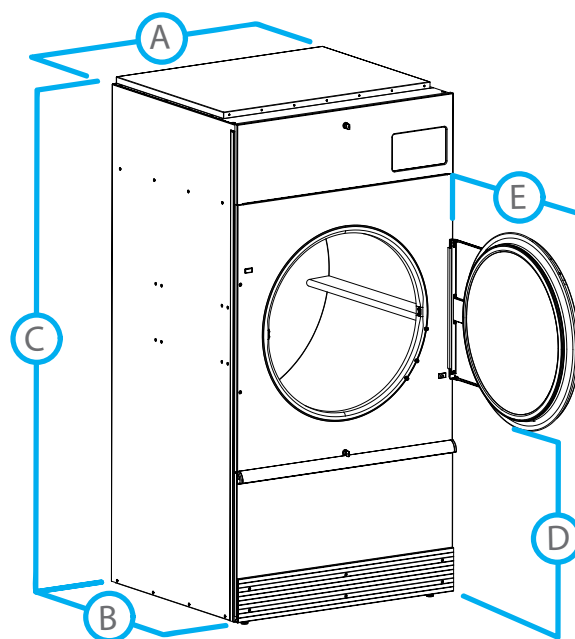

DIMENSIONS	NT120
A. OVERALL WIDTH - in (mm)	46.38 (1178)
B. OVERALL DEPTH - in (mm)	67.92 (1725)
C. OVERALL HEIGHT - in (mm)	Gas/Electric 85.7 (2177)
	Steam 83.5 (2121)
D. DOOR BOTTOM TO FLOOR - in (mm)	31.38 (797)
E. DOOR SWING - in (mm)	32.5 (826)