

ON-PREMISES PREMIUM SINGLE TUMBLE DRYER

NT
RANGE

NT30

30lb



FEATURES

- Easy-to-use digital control
- Electric, gas and steam heating
- Large door opening for easy loading and unloading
- Galvanized cylinder
- Axial airflow
- Large self-cleaning lint screen
- Fits through 36" door opening

OPTIONS

- Reversing cylinder to avoid tangling of large items
- Stainless steel cylinder
- Stainless steel front panel
- Sensodry+® over-dry prevention technology lowers energy, utility and linen replacement costs
- SafeTech™ Fire Suppression System, a multi-port water manifold system, will saturate linens in an unlikely event of fire within the cylinder



FAST DRYING



EASY
OPERATION



SERVICE
FRIENDLY

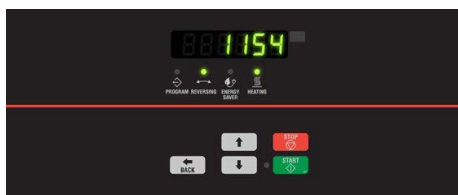

XQ Control

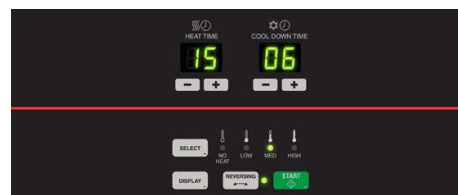

Dual Digital Control



You have plans. We have solutions.

1.844.275.2828 | www.lavxel.com

MODEL		NT 30
CONTROL OPTION		XQ, DDC
CAPACITY - lb (kg)		30 (14)
OVERALL WIDTH - in (mm)		28 (711)
OVERALL DEPTH - in (mm)		46.87 (1190)
OVERALL HEIGHT - in (mm)		63.87 (1622)
CYLINDER DIAMETER - in (mm)		26.5 (673)
CYLINDER VOLUME - cu. ft (liters)		9.6 (272)
DOOR OPENING SIZE - in (mm)		22.69 (576)
ENERGY DATA	Steam Models - 100 psi	134,700 Btu/hr
	Electric Models	21 kW
EXHAUST - in (mm)		6 (152)
GAS CONNECTIONS - in (npt)		0.5
STEAM CONNECTIONS - in (npt)		0.75
MOTOR - hp	Fan	0.25
	Drive	0.25
DRYING AVERAGE - lbs/min	Gas Heating	0.57
	Electric Heating	0.6
AIRFLOW - cfm		500
ELECTRIC SPECS - amps		Non Rev (Rev)
GAS & STEAM	100/200-220/60/1 2W+G	11.0/5.8
	120/208-240/60/1 2W/3W+G	12.0/6.7
	200-208/240/60/3 3W+G	3.2/3.2 (4.0/4.0)
	380/60/3 3W+G	1.5 (2.0)
	440/60/3 3W+G	1.6 (2.0)
	460-480/60/3 3W+G	1.6 (2.0)
	208/60/1 3W+G	108
	240/60/1 3W+G	94
	200/60/1 2W+G	108
	200-208/60/3 3W+G	62 (62)
ELECTRIC	240/60/3 3W+G	54 (54)
	380/60/3 3W+G	33 (33)
	440/60/3 3W+G	29 (29)
	460-480/60/3 3W+G	27 (27)
SHIPPING DIMENSIONS	APPROX. Width	30 (762)
	Depth	49 (1245)
	Height	69 (1753)
NET WEIGHT - lb (kg)		330 (150)
SHIPPING WEIGHT - lb (kg)		364 (165)
AGENCY APPROVALS		cCSAus

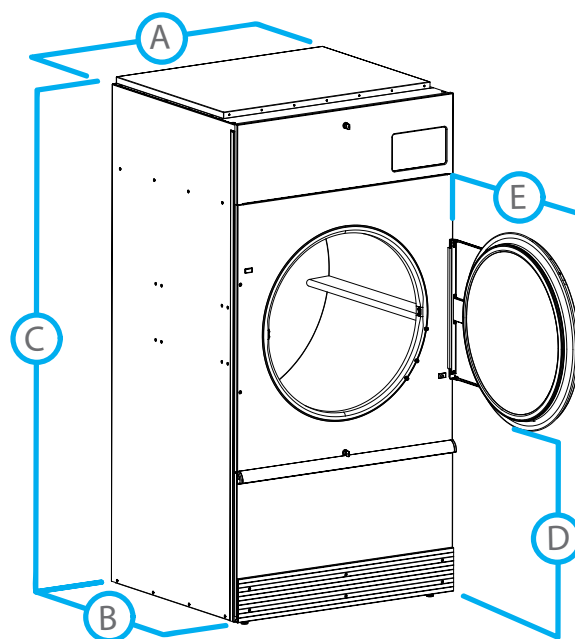

DIMENSIONS		NT30
A.	OVERALL WIDTH - in (mm)	28 (711)
B.	OVERALL DEPTH - in (mm)	46.87 (1190)
C.	OVERALL HEIGHT - in (mm)	63.87 (1622)
D.	DOOR BOTTOM TO FLOOR - in (mm)	27.5 (669)
E.	DOOR SWING - in (mm)	26.25 (667)