

ON-PREMISES PREMIUM SINGLE TUMBLE DRYER

NT35

35lb



FEATURES

- Easy-to-use digital control
- Electric, gas and steam heating
- Large door opening for easy loading and unloading
- Galvanized cylinder
- Axial airflow
- Large self-cleaning lint screen
- Fits through 36" door opening

OPTIONS

- Reversing cylinder to avoid tangling of large items
- Stainless steel cylinder
- Stainless steel front panel
- Sensodry+™ over-dry prevention technology lowers energy, utility and linen replacement costs
- SafeTech™ Fire Suppression System, a multi-port water manifold system, will saturate linens in an unlikely event of fire within the cylinder



FAST DRYING



EASY
OPERATION



SERVICE
FRIENDLY

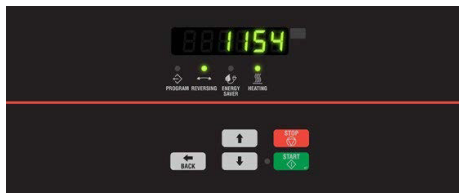

XQ Control

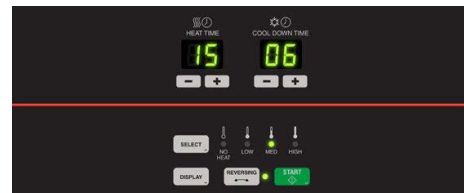

Dual Digital Control



You have plans. We have solutions.

1.844.275.2828 | www.lavxel.com

MODEL		NT 35
CONTROL OPTION		XQ, DDC
CAPACITY - lb (kg)		35 (16)
OVERALL WIDTH - in (mm)		31.5 (800)
OVERALL DEPTH - in (mm)		46.87 (1190)
OVERALL HEIGHT - in (mm)		63.87 (1622)
CYLINDER DIAMETER - in (mm)		30 (762)
CYLINDER VOLUME - cu. ft (liters)		12.3 (348)
DOOR OPENING SIZE - in (mm)		22.69 (576)
ENERGY DATA	Steam Models - 100 psi	166,000 Btu/hr
	Electric Models	24 kW
EXHAUST - in (mm)		8 (203)
GAS CONNECTIONS - in (npt)		0.5
STEAM CONNECTIONS - in (npt)		0.75
MOTOR - hp	Fan	0.25
	Drive	0.25
DRYING AVERAGE - lbs/min	Gas Heating	0.73
	Electric Heating	0.74
AIRFLOW - cfm		650
ELECTRIC SPECS - amps		Non Rev (Rev)
GAS & STEAM	100/200-220/60/1 2W+G	11.0/5.8
	120/208-240/60/1 2W/3W+G	12.0/6.7
	200-208/240/60/3 3W+G	3.2/3.2 (4.0/4.0)
	380/60/3 3W+G	1.5 (2.0)
	440/60/3 3W+G	1.6 (2.0)
	460-480/60/3 3W+G	1.6 (2.0)
	ELECTRIC	
	208/60/1 3W+G	122
	240/60/1 3W+G	107
	200/60/1 2W+G	122
	200-208/60/3 3W+G	71 (71)
	240/60/3 3W+G	62 (62)
	380/60/3 3W+G	38 (38)
	440/60/3 3W+G	33 (33)
	460-480/60/3 3W+G	31 (31)
SHIPPING DIMENSIONS	APPROX. Width	33 (838)
	Depth	49 (1245)
	Height	69 (1753)
NET WEIGHT - lb (kg)		360 (163)
SHIPPING WEIGHT - lb (kg)		394 (177)
AGENCY APPROVALS		cCSAus

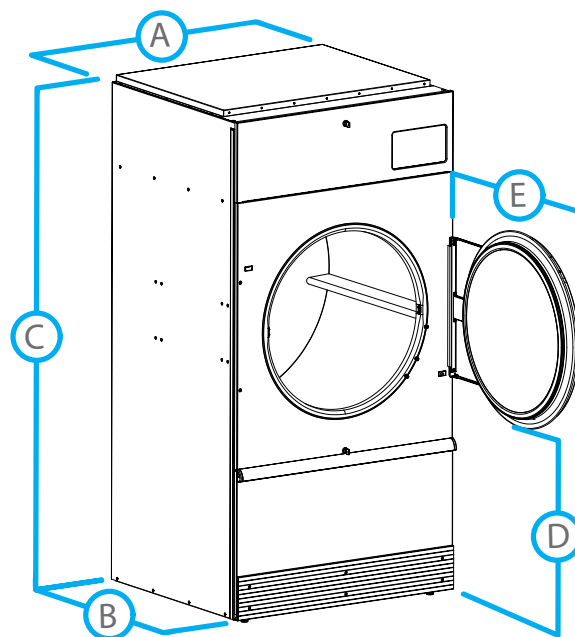

DIMENSIONS		NT 35
A.	OVERALL WIDTH - in (mm)	31.5 (800)
B.	OVERALL DEPTH - in (mm)	46.87 (1190)
C.	OVERALL HEIGHT - in (mm)	63.87 (1622)
D.	DOOR BOTTOM TO FLOOR - in (mm)	27.5 (669)
E.	DOOR SWING - in (mm)	28 (711)