

ON-PREMISES PREMIUM SINGLE TUMBLE DRYER

PT
RANGE

PT050

50lb



FEATURES

- Easy-to-use digital control
- Electric, gas and steam heating
- Large door opening for easy loading and unloading
- Galvanized cylinder
- Radial airflow
- Large self-cleaning lint screen

OPTIONS

- Reversing cylinder to avoid tangling of large items
- Stainless steel cylinder
- Stainless steel front panel
- Sensodry+® over-dry prevention technology lowers energy, utility and linen replacement costs
- SafeTech™ Fire Suppression System, a multi-port water manifold system, will saturate linens in an unlikely event of fire within the cylinder



FAST DRYING



EASY
OPERATION



LARGE DOOR
OPENING

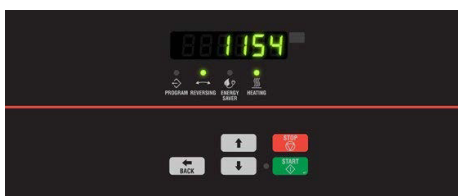

XQ Control

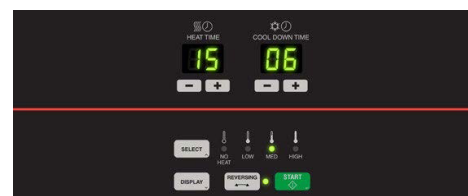

Dual Digital Control



You have plans. We have solutions.

1.844.275.2828 | www.lavxel.com

MODEL			PT050
CONTROL OPTION			XQ, DDC
CAPACITY - lb (kg)			50 (23)
OVERALL WIDTH - in (mm)			38.5 (980)
OVERALL DEPTH - in (mm)			46.8 (1190)
OVERALL HEIGHT - in (mm)			77.3 (1960)
CYLINDER DIAMETER - in (mm)			37 (940)
CYLINDER VOLUME - cu. ft (liters)			18.7 (5 30)
DOOR OPENING SIZE - in (mm)			26.88 (683)
ENERGY DATA	Steam Models - 100 psi		113,600 Btu/h
	Electric Models		30 kW
	Gas Models		130,000 Btu/h
EXHAUST - in (mm)			8 (203)
GAS CONNECTIONS - in (npt)			0.75
STEAM CONNECTIONS - in (npt)			0.75
MOTOR - hp	Fan		0.5
	Drive		0.5
DRYING AVERAGE - lbs/min	Gas Heating		1
	Electric Heating		0.85
AIRFLOW - cfm			700
ELECTRIC SPECS - amps			
GAS & STEAM	100-120V/50-60Hz/1Ph		9
	200-240V/50-60Hz/1-3Ph		6
	440-480V/50-60Hz/3Ph		3
	380-415V/50-60Hz/3Ph		3
ELECTRIC	230-240V/50-60Hz/1Ph		91
	200-208V/50-60Hz/3Ph		87
	230-240V/50-60Hz/3Ph		75
	380V/50-60Hz/3Ph		47
	400-415V/50-60Hz/3Ph		43
	440V/50-60Hz/3Ph		41
	460-480V/50-60Hz/3Ph		38
SHIPPING DIMENSIONS - in (mm)	APPROX.	Width	41.5 (1050)
		Depth	50 (1270)
		Height	81 (2060)
NET WEIGHT - lb (kg)		Gas	650 (295)
		Steam	690 (315)
		Electric	380 (310)
SHIPPING WEIGHT - lb (kg)		Gas	700 (320)
		Steam	740 (335)
		Electric	730 (330)
AGENCY APPROVALS			cCSAus

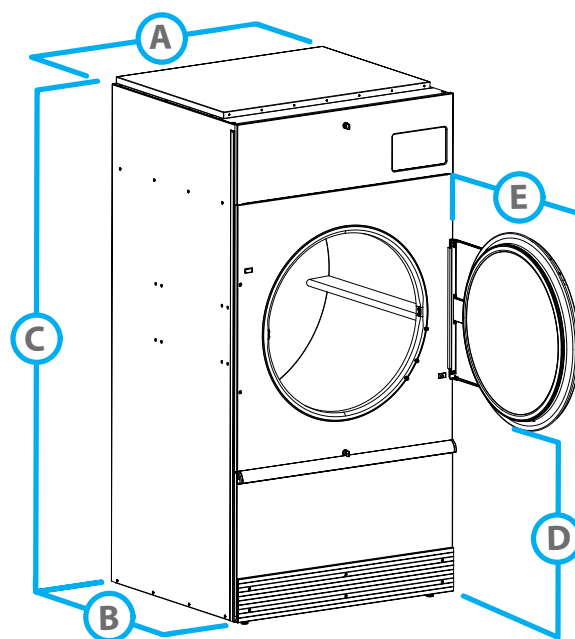

DIMENSIONS		PT050
A.	OVERALL WIDTH - in (mm)	38.5 (980)
B.	OVERALL DEPTH - in (mm)	46.8 (1190)
C.	OVERALL HEIGHT - in (mm)	77.3 (1960)
D.	DOOR BOTTOM TO FLOOR - in (mm)	29.2 (740)
E.	DOOR SWING - in (mm)	33.9 (860)