

# ON-PREMISES PREMIUM SINGLE TUMBLE DRYER

NT  
RANGE

NT55

55lb



## FEATURES

- Easy-to-use digital control
- Electric, gas and steam heating
- Large door opening for easy loading and unloading
- Galvanized cylinder
- Axial airflow
- Large self-cleaning lint screen
- Fits through 36" door opening

## OPTIONS

- Reversing cylinder to avoid tangling of large items
- Stainless steel cylinder
- Stainless steel front panel
- Sensodry+™ over-dry prevention technology lowers energy, utility and linen replacement costs
- SafeTech™ Fire Suppression System, a multi-port water manifold system, will saturate linens in an unlikely event of fire within the cylinder



FAST DRYING



EASY  
OPERATION



SERVICE  
FRIENDLY

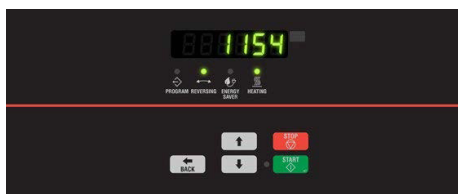

XQ Control

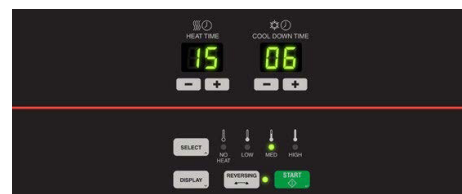

Dual Digital Control



*You have plans. We have solutions.*

1.844.275.2828 | [www.lavxel.com](http://www.lavxel.com)

MODEL		NT 55
CONTROL OPTION		XQ, DDC
CAPACITY - lb (kg)		55 (25)
OVERALL WIDTH - in (mm)		34.5 (876)
OVERALL DEPTH - in (mm)		53.62 (1362)
OVERALL HEIGHT - in (mm)		66.72 (1695)
CYLINDER DIAMETER - in (mm)		33 (838)
CYLINDER VOLUME - cu. ft ( liters)		17.3 (490)
DOOR OPENING SIZE - in (mm)		26.88 (683)
ENERGY DATA	Electric Models	27 kW
EXHAUST - in (mm)		8 (203)
GAS CONNECTIONS - in (npt)		0.5
MOTOR - hp	Fan	0.5
	Drive	0.5
DRYING AVERAGE - lbs/min	Gas Heating	0.98
	Electric Heating	0.88
AIRFLOW - cfm		700
ELECTRIC SPECS - amps		Non Rev (Rev)
GAS & STEAM	100/200-220/60/1 2W+G	9.8
	120/208-240/60/1 2W/3W+G	9.2/6.5
	200-208/240/60/3 3W+G	4.0/4.0 (4.0/4.5)
ELECTRIC	208/60/1 3W+G	129
	240/60/1 3W+G	115
	200/60/1 2W+G	122
	200-208/60/3 3W+G	79 (79)
	240/60/3 3W+G	65 (65)
SHIPPING DIMENSIONS - in (mm)	APPROX. Width	35.5 (902)
	Depth	59 (1499)
	Height	72 (1829)
NET WEIGHT - lb (kg)		435 (197)
SHIPPING WEIGHT - lb (kg)		476 (216)
AGENCY APPROVALS		cCSAus

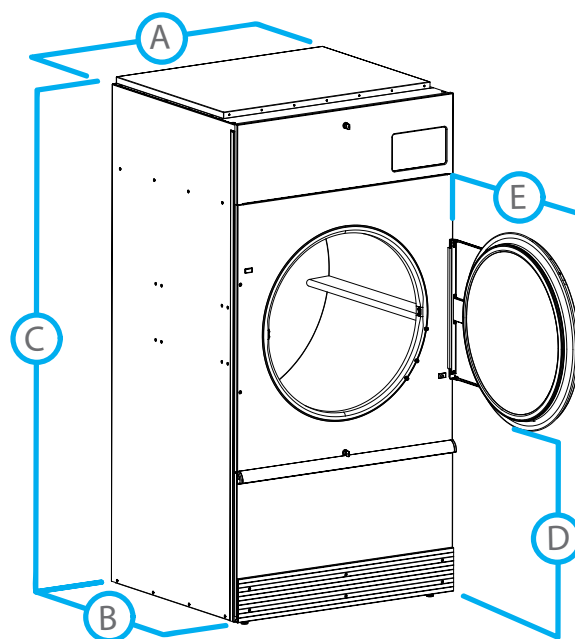

DIMENSIONS		NT55
A.	OVERALL WIDTH - in (mm)	34.5 (876)
B.	OVERALL DEPTH - in (mm)	53.62 (1362)
C.	OVERALL HEIGHT - in (mm)	66.72 (1695)
D.	DOOR BOTTOM TO FLOOR - in (mm)	26.88 (683)
E.	DOOR SWING - in (mm)	31.88 (810)