

# ON-PREMISES PREMIUM SINGLE TUMBLE DRYER

NT75

75lb



## FEATURES

- Easy-to-use digital control
- Electric, gas and steam heating
- Large door opening for easy loading and unloading
- Galvanized cylinder
- Radial airflow
- Large self-cleaning lint screen

## OPTIONS

- Reversing cylinder to avoid tangling of large items
- Stainless steel cylinder
- Stainless steel front panel
- Sensodry+® over-dry prevention technology lowers energy, utility and linen replacement costs
- SafeTech™ Fire Suppression System, a multi-port water manifold system, will saturate linens in an unlikely event of fire within the cylinder



FAST DRYING



EASY  
OPERATION



SERVICE  
FRIENDLY

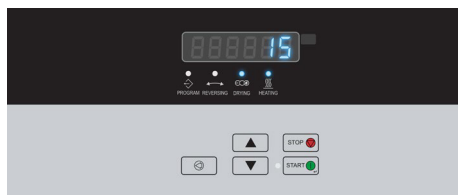

XQ Control

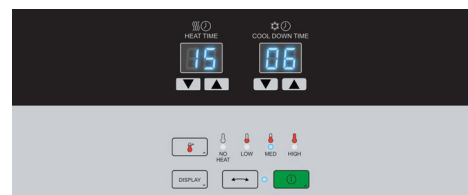

Dual Digital Control



*You have plans. We have solutions.*

1.844.275.2828 | [www.lavxel.com](http://www.lavxel.com)

| MODEL                             |                        | NT 75         |
|-----------------------------------|------------------------|---------------|
| CONTROL OPTION                    |                        | XQ, DDC       |
| CAPACITY - lb (kg)                |                        | 75 (34)       |
| OVERALL WIDTH - in (mm)           |                        | 38.5 ( 980)   |
| OVERALL DEPTH - in (mm)           |                        | 53 (1350)     |
| OVERALL HEIGHT - in (mm)          |                        | 77.3 ( 1960)  |
| CYLINDER DIAMETER - in (mm)       |                        | 37 (940)      |
| CYLINDER VOLUME - cu. ft (liters) |                        | 22.4 (634)    |
| DOOR OPENING SIZE - in (mm)       |                        | 26.88 (683)   |
| ENERGY DATA                       | Steam Models - 100 psi | 133,900 Btu/h |
|                                   | Electric Models        | 36 kW         |
|                                   | Gas Models             | 165,000 Btu/h |
| EXHAUST - in (mm)                 |                        | 8 (203)       |
| GAS CONNECTIONS - in (npt)        |                        | 0.75          |
| STEAM CONNECTIONS - in (npt)      |                        | 0.75          |
| MOTOR - hp                        | Fan                    | 0.5           |
|                                   | Drive                  | 0.5           |
| DRYING AVERAGE<br>- lbs/min       | Gas Heating            | 1.36          |
|                                   | Electric Heating       | 0.82          |
| AIRFLOW - cfm                     | Gas/Steam              | 800           |
|                                   | Electric               | 800           |
| ELECTRIC SPECS - amps             |                        |               |
| GAS & STEAM                       | 100-120V/50-60Hz/1Ph   | 12            |
|                                   | 200-240V/50-60Hz/1-3Ph | 7             |
|                                   | 440-480V/50-60Hz/3Ph   | 3             |
|                                   | 380-415V/50-60Hz/3Ph   | 3             |
| ELECTRIC                          | 200-208V/50-60Hz/3Ph   | 104           |
|                                   | 230-240V/50-60Hz/3Ph   | 90            |
|                                   | 380V/50-60Hz/3Ph       | 56            |
|                                   | 400-415V/50-60Hz/3Ph   | 52            |
|                                   | 440V/50-60Hz/3Ph       | 49            |
|                                   | 460-480V/50-60Hz/3Ph   | 45            |
| SHIPPING DIMENSIONS<br>- in (mm)  | Width                  | 41.5 (1054)   |
|                                   | Depth                  | 56 (1420)     |
|                                   | Height                 | 81 ( 2060)    |
| NET WEIGHT - lb (kg)              | Gas                    | 680 (310)     |
|                                   | Steam                  | 720 (325)     |
|                                   | Electric               | 710 (320)     |
| SHIPPING WEIGHT - lb (kg)         | Gas                    | 730 (330)     |
|                                   | Steam                  | 770 (350)     |
|                                   | Electric               | 760 (340)     |
| AGENCY APPROVALS                  |                        | cCSAus        |

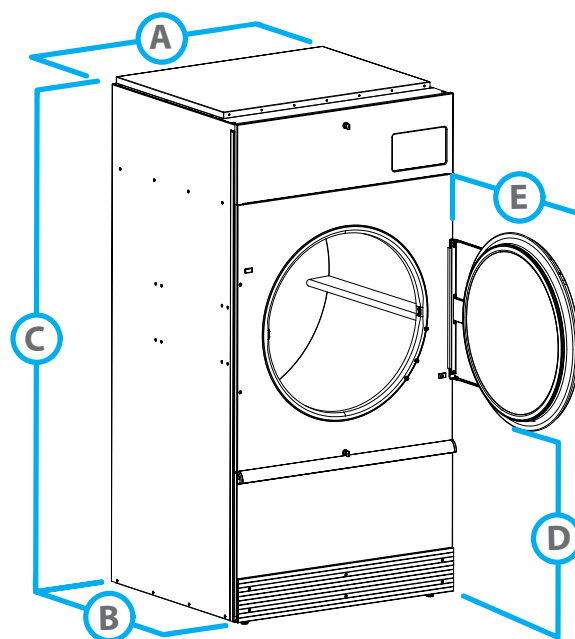

| DIMENSIONS |                                | NT75        |
|------------|--------------------------------|-------------|
| A.         | OVERALL WIDTH - in (mm)        | 38.5 ( 980) |
| B.         | OVERALL DEPTH - in (mm)        | 53 (1350)   |
| C.         | OVERALL HEIGHT - in (mm)       | 77.3 (1960) |
| D.         | DOOR BOTTOM TO FLOOR - in (mm) | 29.2 (740)  |
| E.         | DOOR SWING - in (mm)           | 33.9 (860)  |