



TUMBLE DRYERS | GREEN EVOLUTION



Tumble Dryers

FD - 65 TP2

FD - 80 TP2

ADVANCE

HIGH PERFORMANCE, EFFICIENT
TECNOLOGY, ADVANCE DRYING



- Fully programmable Touch Plus Control Processor (TP2) with 4.3" touchscreen.



- Ergonomic door with a large opening and the option of double glazing.
- Anti-wrinkle system.
- End of cycle tone.
- Emergency stop button and security micro magnet to stop operation.
- Motion transmission by pulley and Poly-V belts with the drum supported by wheel on models between 65 and 80 lb.

FEATURES

- External steel casing with grey coating (skinplate), stainless steel, easy to clean finish.
- Stainless steel drum.
- Axial-radial airflow, resulting in greater drying efficiency.
- Drum with stamped perforations for the gentle treatment of fabrics.
- Lint filter at the bottom, more ergonomic, larger and improved airflow.
- Automatic reverse rotation of the drum.
- Frequency inverter for smoother operation.

OPTIONS:

- iDry System (Intelligent moisture sensor)
- FK System (Integrated fire prevention system).
- 7" screen touchscreen.
- OPL ↔ Vended
Fagor dryers can be easily converted from OPL to Self-Service and viceversa.



ONNERA GROUP

ONNERA USA, Inc
13105 NW 47th Ave
Opa-locka, Florida 33054
USA

www.fagorcommercial.com



TECHNICAL DATA		UNIT.	FD- 65	FD- 80		
CAPACITY						
Capacity 1/18	lb		70	80		
Capacity 1/20	lb		60	75		
Hourly Output *	lb/h		59,3	138 / 9		
Evaporation capacity *	l/h		30,9	32,1		
DRUM						
Ø Drum	in		37.25	37.25		
Ø Door	in		31.50	31.50		
Door center height	in		41	41		
Load hole bottom height	in		64.50	64.50		
Drum length	in		30.75	36.85		
Drum volume	cu ft		19.4	23.3		
POWER						
Drum motor power	hp		0,75	0,75		
Fan motor power	hp		0,75	0,75		
Electric heating power	kW		30	36		
Total electric power (elec.model)	kW		31,15	37,15		
Gas heating power	btu/h		140,000	140,000		
Total electric power (gas model)	kW		1,15	1,15		
Steam heating power	kW		50,1	50,1		
Steam heating power (gas model)	kW		1,15	1,15		
CONNECTIONS			ELECTRICAL	STEAM / GAS	ELECTRICAL	STEAM / GAS
Tension 120 V - I / 230V - I + N + T	Nº x mm2 / A		-	3 x 1,5 / 20A	-	3 x 1,5 / 20A
Tension 230V - III + T	Nº x mm2 / A		4 x 35 / 100A	3 x 1,5 / 20A	4 x 50 / 125A	3 x 1,5 / 20A
Frequency	Hz		-	60	-	60
Ø Gas inlet	BSP		1/2"		1/2"	
Ø Steam inlet	BSP		1"		1"	
Ø Condensed (Steam models)	BSP		1"		1"	
DIMENSIONS / PACKING DIMENSIONS						
Net Width / Gross Width	in		38.75 / 42		38.75 / 42	
Net Depth / Gross Depth	in		41.50 / 45.50		47.60 / 51.60	
Net Height / Gross Height	in		76.60 / 82		76.60 / 82	
Height without heating battery	in		-		-	
Net weight / Gross weight	lb		507 / 573		573 / 628	
OTHERS						
Max airflow	CFM		706		706	
Ø Duct Size	in		8		8	
Sound level	dB		65		65	

* It may vary depending on the type of heating, filter cleanliness or extraction type.

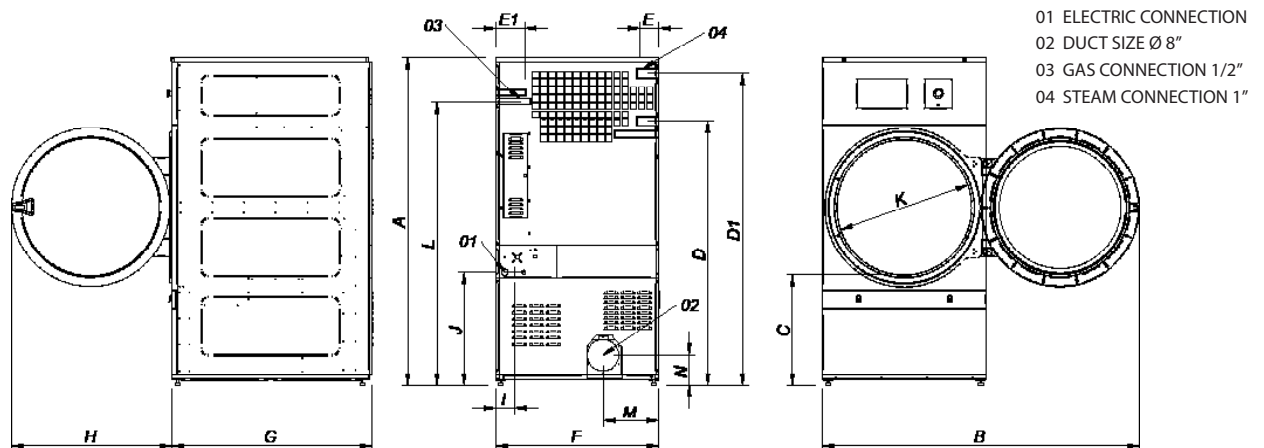

	A	B	C	D	D1	E	E1	F	G	H	I	J	K	L	M	N
FD-65	76.60	75	25	62.60	74	4.50	6.85	38.75	41.50	37.75	4.30	26.75	31.60	67.25	13.35	7
FD-80	76.60	75	25	62.60	74	4.50	6.85	38.75	47.60	37.75	4.30	26.75	31.60	67.25	13.35	7

